

# STONE ARCH BRIDGE

V.Ryan © 2000 - 2009

On behalf of The World Association of Technology Teachers

## W.A.T.T.



World Association of Technology Teachers

This exercise can be printed and used by teachers and students. It is recommended that you view the website ([www.technologystudent.com](http://www.technologystudent.com)) before attempting the design sheet .

THESE MATERIALS CAN BE PRINTED AND USED BY TEACHERS AND STUDENTS.  
THEY MUST NOT BE EDITED IN ANY WAY OR PLACED ON ANY OTHER MEDIA INCLUDING WEB SITES AND INTRANETS.  
NOT FOR COMMERCIAL USE.  
THIS WORK IS PROTECTED BY COPYRIGHT LAW.  
IT IS ILLEGAL TO DISPLAY THIS WORK ON ANY WEBSITE/MEDIA STORAGE OTHER THAN [www.technologystudent.com](http://www.technologystudent.com)

# STONE ARCH BRIDGE

V.Ryan © 2009 World Association of Technology Teachers

1. The stone arch bridge drawn below is almost complete. Complete the drawing by adding the missing stones. Identify the key stone with an arrow.

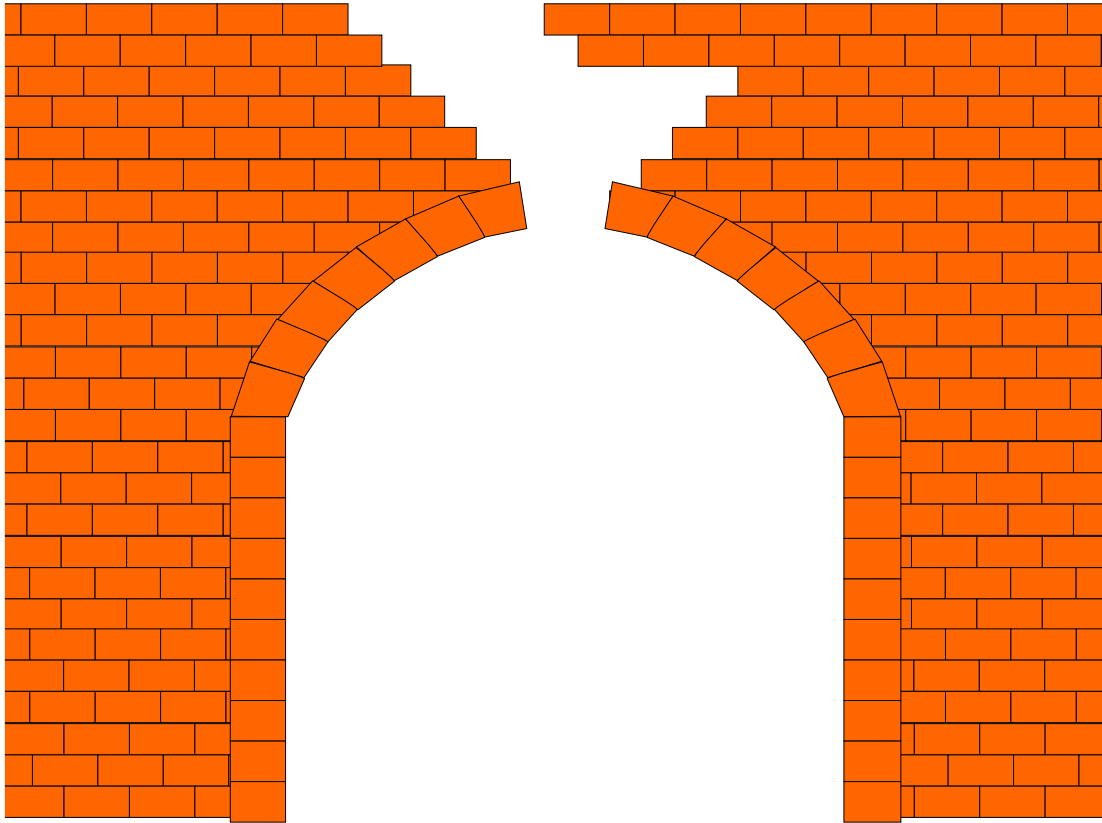

2. Why is the keystone the most important stone in this type of bridge?

---

---

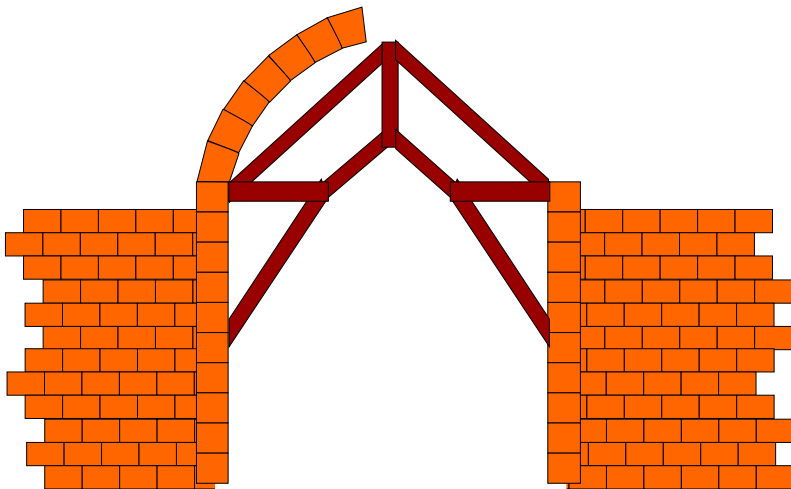

3. The Romans constructed stone arches by using a wood frame, on which the stones were positioned. Complete the drawing opposite by;

Adding the missing parts of the wood frame.

Adding the remaining stones of the arch. These should rest on the wood frame.

Name a famous stone arch bridge and its location.

NAME: \_\_\_\_\_  
\_\_\_\_\_

LOCATION: \_\_\_\_\_  
\_\_\_\_\_