

NUTS AND BOLTS

V.Ryan © 2000 - 2008

On behalf of The World Association of Technology Teachers

W.A.T.T.



World Association of Technology Teachers

The 'Nuts and Bolts Exercise' can be printed and used by teachers and students. It is recommended that you view the website (www.technologystudent.com) before attempting the design sheet.

THESE MATERIALS CAN BE PRINTED AND USED BY TEACHERS AND STUDENTS.
THEY MUST NOT BE EDITED IN ANY WAY OR PLACED ON ANY OTHER MEDIA INCLUDING WEB SITES AND INTRANETS.
NOT FOR COMMERCIAL USE.
THIS WORK IS PROTECTED BY COPYRIGHT LAW.
IT IS ILLEGAL TO DISPLAY THIS WORK ON ANY WEBSITE/MEDIA STORAGE OTHER THAN www.technologystudent.com

TYPES OF BOLTS

V.Ryan © 2008 World Association of Technology Teachers

MACHINE SCREW - COUNTERSUNK HEAD

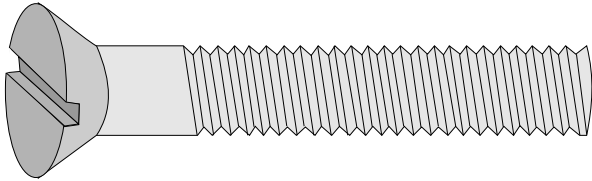

WING NUT

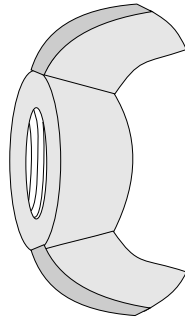

1. The bolt seen opposite is a Countersunk Head Machine Bolt. A wing nut is used in place of a typical nut. Give one advantage and disadvantage of using a wing nut.

ADVANTAGE: _____

DISADVANTAGE: _____

MACHINE SCREW - ROUND HEAD

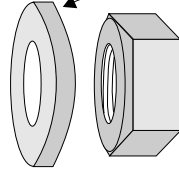
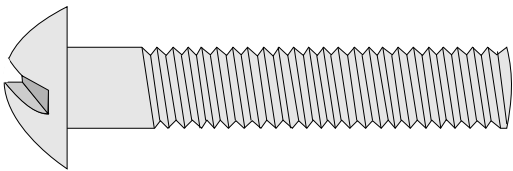

PLAIN WASHER

2. The Round Head Machine Screw seen opposite has a washer. Why are washers often required with machine screws?

Pan Head Screw, Spring Washer and Nut

3. In the space opposite, draw a Pan Head machine screw with a spring washer and nut.